

## Insulation Placement for Slabs above Frost Line (9.36.2.8)

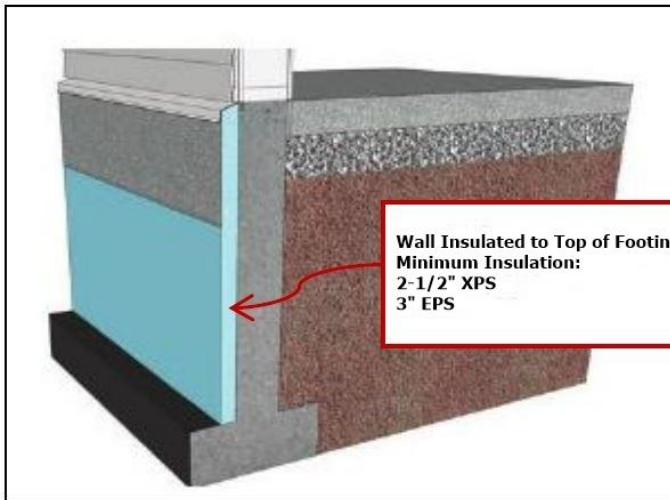

9.36.2.8.(4)(a)

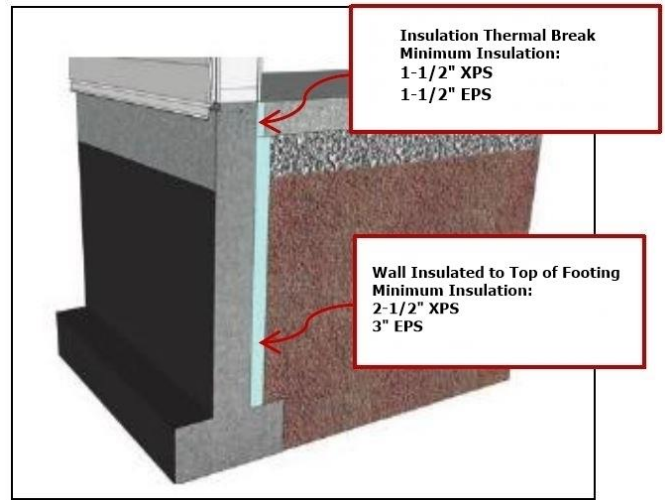

9.36.2.8.(4)(b)(i)

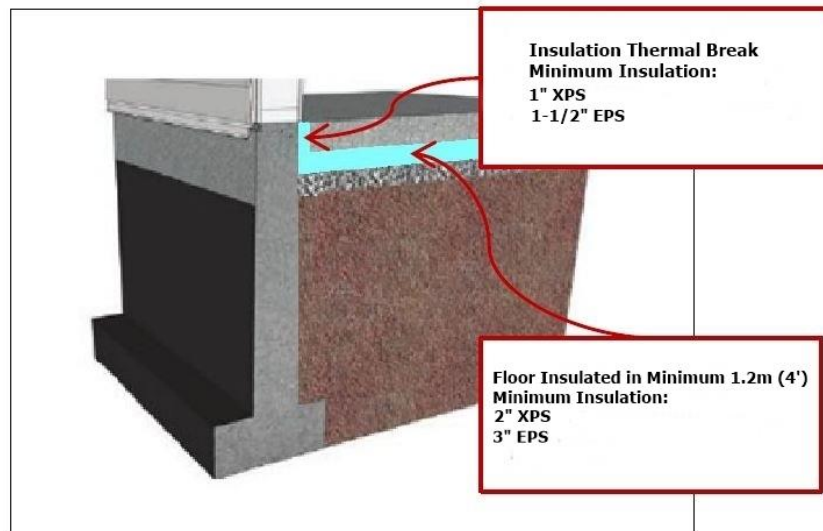

9.36.2.8.(4)(b)(i)

**Required Insulation Value: RSI 1.96/U-Value 0.510/ R-Value 11.11**

**XPS:** Extruded Foam (Examples: SM/Celfort/Codebord/Foamular)

**EPS:** Expanded Foam (Examples: Foundation Plus/Thermalite/Durofoam)

Credit: Illustrated Guide: Energy Efficiency Requirements for Houses in British Columbia

## Insulation Placement for Slabs above Frost Line (9.36.2.8)

### Slabs with in-floor heating “Heated Slab/Heated Floor”

Required Insulation Value: RSI 2.32/U-Value 0.431/ R-Value 13.2

2-1/2” of XPS or 3-1/2” of EPS under the full heated floor slab and edges

The foundation wall may also be required to be insulated

### WHAT IF ONLY A PORTION OF MY FLOOR IS GOING TO BE HEATED?

If you're only putting heating ducts, cables or pipes in a portion of your floor, you'll need to make sure:

1. That the heated part of the floor meets the minimum effective R-values for heated floors, and
2. That the minimum effective R-value is also met for floor areas within 4 ft (1.2 m) of the heated portion.

The diagram to the right demonstrates this.

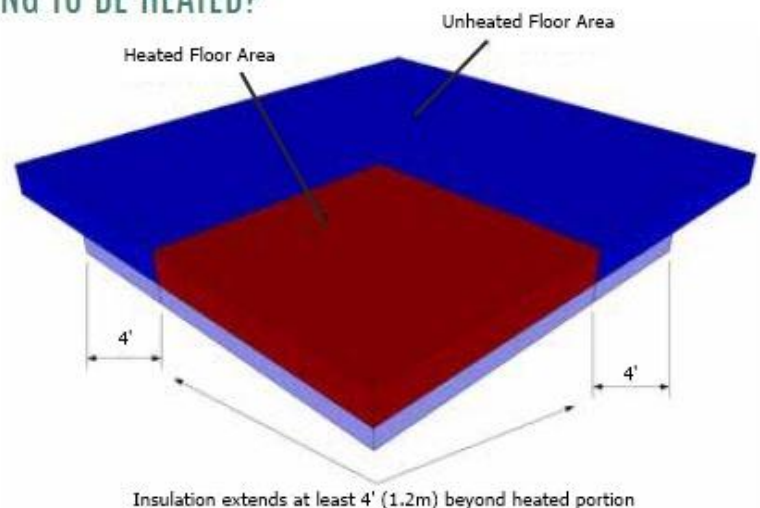

Credit: Guide to Building Energy Efficient Homes and Small Buildings 2016-Newfoundland & Labrador